

SEVENTY



Technical specifications



LAGOON

**Contents**

Technical datas.....	4
Construction.....	5
Mooring.....	5
Propulsion and steering gear.....	5
Fuel system.....	5
Freshwater system.....	6
Grey water and black water systems .....	6
Bilge evacuation system.....	6
Electrical system .....	7
Lighting.....	8
Ventilation and extraction system.....	9
Deck fittings.....	10
Equipment and finishes and interior design .....	12
Saloon – Galley up version .....	14
5 cabins – Galley up version.....	16
6 cabins – Galley up version.....	21
Saloon – Hull Galley version .....	26
4 cabin version – Forward galley .....	28
5 cabin version – Forward galley.....	34
3 cabin version – Aft galley .....	40
4 cabin version – Aft galley.....	46

**Technical datas**

Length overall	23,80 m / 78'1"
Length on waterline	23,60 m / 77'5"
Beam overall	11,00 m / 36'1"
Draft	1,27 m / 4'2"
Displacement (EC)	62,2 t / 137 151 Lbs
Fuel capacity	8500 l / 2246 US gal
Fresh water capacity	2 x 800l / 2 x 211 US gal
Grey water capacity	2 x 300 l / 79 US gal
Black water capacity	73 l / 79 US gal par salle d'eau
Engines	Volvo D11-510 hp or John Deere N13-580 hp
Architects	VPLP Design
Exterior design	Patrick Le Quément
Interior design	Nauta Design
Design category	A : 14 - B : 18 - C : 24 - D : 40

**Construction**

- Deck : polyester resin infusion process on balsa core
- Hull and roof : vinylester resin infusion process on balsa core
- Hull bottoms and keels in solid infused laminate

**Mooring**

- Anchor chain path incorporated into forward platform
- 1 electric windlass with horizontal gypsy QUICK 3500W 24V (chain 16mm) and remote control
- Chain locker located to port of the windlass
- 13 mooring cleats
- 4 fairleads

**Propulsion and steering gear**

- 2 diesel engines VOLVO D11-510 cv common rail, shaft line assembly
- 2 propellers BRUNTONS Ø 816 mm - 5 fixe blades
- Seawater filter
- Electric engine control at central helm station on flybridge
- 2 spade rudders: foam sandwich and stainless steel stock
- Epoxy rudder tubes
- Self-aligning upper and lower rudder bearings
- Electro Hydraulic transmission (1 actuator per rudder)
- Hydraulic pump in engine compartment
- Engine bilge ventilation: natural aspiration and forced extraction in aft beam
- Engine compartment soundproofing

**Fuel system**

- Two aluminum tanks of 1400 liters + 2 x 2850 liters. Gauge on general distribution panel.
- Primary filter and water separator with sensor and filter
- Fuel shutoff valve
- Fuel shutoff remote controls

## **Freshwater system**

- Freshwater tanks: 2 x 800 liters. Gauge on general distribution panel
- Freshwater system with 2 x 24V 36l/min pumps
- Hot water system with 2 x 100 liters water heaters with 230V heating element and engine heat exchanger
- Foolproof freshwater fillers on deck
- Freshwater intake on starboard transom
- Freshwater/seawater deck wash pump forward cockpit
- Freshwater deck wash pump aft cockpit

## **Grey water and black water systems**

Grey water:

- Grey water tanks : 2 x 300 liters with gauge at general distribution panel
- Shower/washbasin and galley sink drained to grey water tank and automatic pump
- Manual and/or automatic tanks draining from the general panel
- Rainwater drains directly into the sea

Black water:

- TECMA Silence Plus electric freshwater toilet in each head 24V
- Black water tanks :
  - Port :
    - All versions : 1 tank per toilet (73 liters)
  - Starboard :
    - 2 cabin version: 1 common tank for owner and guest bathrooms (320 liters)
    - 3 cabin version: 1 tank per toilet (73 liters)
- Tank levels are monitored as standard from the main panel
- Solenoid valve for the black water draining in the owner and guest cabins.
- Manual valve for the crew cabin

## **Bilge evacuation system**

- Self- bailing cockpit in accordance with EC standards
- 2 manual bilge pumps operated from the cockpit (aft cockpit seat)

- 1 electric bilge pump with automatic float switch and manual override + bilge sump level alarm in each hull
- 1 electric bilge pump with automatic float switch and manual override + bilge sump level alarm in each engine compartment
- Alarms and controls:
  - Sump level alarm at the chart table and on the flybridge
  - 24V AC electric pump control panel incorporated into the main panel
  - Bilge pump switch at navigation station

## **Electrical system**

### Electrical panels:

- Main panels AC/DC, port forward passageway
- Secondary AC & DC electrical panels installed in all areas of the vessel

### 230 V AC, 50Hz sources for:

- Shore power supply : 63 Ah as standard
- Alternators : 2 x 80 Ah 24V (D11-510 hp Volvo)
- Generator : ONAN 13,5 kva *starboard engine compartment*
- Inverter : VICTRON 2000 VA 24/230V

### V DC sources with negative earth for:

- Batteries :
  - Main batteries 1050 Ah 24V
  - Engine batteries 75 Ah 12V
- Battery charger : VICTRON Skilla 100 Ah 230V

### 230V AC distribution:

- BUS A
  - Sockets
  - Sockets in technical compartments
  - Engine starting battery charger
  - Bow thruster battery charger (optional)

- Grey water treatment system (optional)
- Electrical appliances in the galley
  - o Oven
  - o Hob
  - o Extractor hood
  - o Dishwasher (optional)
  - o Microwave oven (optional)
  - o Coffeemaker (optional)
  - o Washing machine (optional)
  - o Dryer (optional)
  - o Washer-dryer (optional)
- BUS B
  - Service battery chargers
- BUS C
  - Air handlers (option)
- BUS D
  - HiFi and video (option)
  - Standard fridge in the galley

## Sockets

- In the saloon: 13 sockets in total:
  - Port: 2 in the sofa base + 2\* in the cabinet
  - Starboard: 2 in the sofa base + 1\* in the HiFi cabinet
  - Forward lounge: 3 in the skirting + 2\* in the bar cabinet
  - Chart table: 1
- In the galley: 6 sockets
- In the cabins: 1 socket\* per bedhead + 1 in the skirting

(\*)Each 230V socket comes with a USB socket (except in bases/skirting)

## Lighting

Engine and generator compartment:

- 2 x 24V DC neon lamps are installed in the engine and generator compartment

Owner, VIP and guest cabins:

- LED spotlights and LED striplights in the ceiling
- LED lamps at the bedhead: Tolomeo Artemide
- LED courtesy striplights under the shelves and the furniture
- Dimmer switches alongside the entrance door and by the bed

Saloon:

- LED spotlights and LED striplights in the ceiling
- Dimmer switches alongside the entrance door, in the passageways and at the navigation station
- LED courtesy striplights under the shelves and bar cabinet
- 24V LED reading light at the chart table

Galley:

- LED spotlights and LED striplights under the furniture
- Dimmer switches

Bathrooms:

- LED spotlights

## **Ventilation and extraction system**

Internal ventilation:

- Each cabin and each bathroom has at least one source of natural ventilation
- Aft starboard and forward port bathrooms are equipped with an extractor fan for the toilets with a dedicated control

Engine compartment ventilation:

- 2 x 24V DC electric fans
- Control of the engine compartment ventilation system connected to each engine



## Deck fittings

### FLYBRIDGE

- Access from cockpit via spiral staircase with teak steps on white-painted aluminum frame
- Hatch for manual closing of access to the flybridge
- Central forward helm station with :
  - Helmsman seat
  - Stainless steel covered wheel
  - Power steering (electric + hydraulic system)
  - Navigation instrument pod
  - Compass
  - Engine controls and panel
  - Windlass control and chain counter
  - Lighting control panel
- Large bench on starboard
- Bar cabinet on port :
  - Countertop in Corian® DOVE with integrated sink
  - Storage behind door
  - Waste bin with top access
  - Fridge 65 L
- Sofa/diner corner on starboard : bench with 2 lockers under seat + 2 foldable teak tables with stainless steel fix pedestal

### DECK

- Aft cockpit deck, transom skirt, side decks and forward cockpit in teak
- Deck hatches:
  - Lewmar T60 flush
  - Lewmar T77 flush for forepeak
- Lighting :
  - LED spotlights in the ceiling
  - LED strip lights under benches
  - LED strip lights under transom skirt and deck steps

- LED spotlights along the bulwarks and forward platform
- Safety:
  - 880 mm stainless steel pushpits
  - 300 mm composite bulwark
  - 1 row of lifelines
  - Retractable aft lifelines on transom skirts
  - Pulpits with wooden seat

#### AFT PLATFORM AND TRANSOM SKIRTS

- Stainless steel foldable and removable bathing swimming ladder + hot and cold shower on starboard
- Shore power input socket on starboard transom skirt (63A)
- Freshwater inlet on starboard transom skirt

#### AFT COCKPIT

- Cockpit level with saloon
- L-shaped bench seat with 3 storage lockers on starboard
- Teak table 2.3 x 1.2 m
- 3 outdoor chairs (Brand : Tribu)
- Lazy boy with 2 storage lockers
- 2 sunbathing areas, port and starboard, with a locker in each area
- Starboard aft beam equipment :
  - Stainless steel cupholder
  - Storage behind doors + drawers
  - Corian® DOVE worktop
  - Sink below composite cover
  - Cockpit fridge 65 L
- Port aft beam equipment:
  - Cupholder
  - Storage behind doors + drawers
  - Corian® DOVE worktop
- Storage for 2 liferafts under cockpit floor

- 2 storage lockers under cockpit floor

#### FORWARD COCKPIT

- Access from the saloon by way of a glass door (PMMA)
- 2 seating areas with 1 storage locker under port seating and maintenance access on starboard

#### FOREDECK

- 4 storage lockers including one dedicated to anchoring
- Teak forward platform

#### FOREPEAKS

- Forepeaks with access through deck hatches
- Starboard forepeak :
  - Stainless steel ladder
  - Sole Floor
  - White paint
- Port forepeak:
  - Stainless steel ladder
  - Sole Floor
  - White paint
  - Workshop equipped with stainless steel worktop and multiple storage areas (Available for Galley up & Aft Galley versions)

### **Equipment and finishes and interior design**

#### INTERIOR FINISHES:

*The following specifications may change according to the layout version selected*

- Furniture and bulkheads in Alpi® grey oak with UV-resistant varnish
- Floor in Alpi Kord Wengé
- Head and shower floorings in Corian® (Clam Shell)
- Bathroom vanity top in Corian® (Clam Shell)

- Ceiling: Vinyl (White)
- Roof frame: Vinyl (Meteor & Macadamia)
- Saloon gunwale in leatherette (Bison)
- Saloon furniture tops in leatherette (Bison)
- Chart table and desk in leatherette (Bison)
- Desk in cabin (Bison)
- Bedside table insert in leatherette (Navajo Ivory)
- Sofa and stool in fabric (Sunbrella Clay)
- Leather chair (FRAG - Taupe)
- Saloon dining table with stainless steel insert
- Bedhead in fabric (Sunbrella - Canvas)
- Bed frame (Sunbrella - Sepia)
- Locker handles in brushed stainless steel
- Doors with leatherette insert (Bison)
- Owner's cabin sliding door insert in fabric (Sunbrella - Canvas)
  
- Crew area:
  - Furniture and bulkhead in white laminate
  - Furniture details and kickers in grey laminate
  - Laminated flooring (Brown Oak)
  - Galley countertop in Corian® (Deep Mink)
  - Bed frame (Sunbrella - Nature Grey)
  - Fabric upholstery (Sunbrella - Nature Grey)
  - Crew desk in leatherette ( Grey - Peninsula)

#### Mattresses and upholstery:

- Mattresses made of high resistance honeycomb foam. Air space 3D technology, (35kg/m<sup>3</sup>)
- Blackout roller curtains in cabins
- Blackout roller curtains in saloon
- Mosquito net and shutter for deck hatches

## Saloon - Galley up version



- Access from the aft cockpit through a wide glazed sliding door (overall dimensions 3.8 x 1.95 m/12'6" x 6'5" - opening dimensions 2.3 x 1.95 m/7'7" x 6'5")

### TO PORT

- Galley :
  - Combined refrigerator/freezer with integrated icemaker (Samsung - Volume 396 L+124 L/105 US Gal+33 US Gal)
  - Corian® (Deep Mink) worktop with stainless steel double sink and hot and cold mixer tap
  - 1 x 4-burner induction hob 230V (Miele) and pan clamps
  - 1 extractor hood (Electrolux)
  - 1 low-level unit with 3 drawers and 2 doors
  - 1 low-level sliding waste receptacle
  - High-level sliding locker with two shelves
  - 2 high-level shelves (Slot for optional microwave)
- Central island:
  - 1 low-level locker with 5 drawers and 1 door (Slot for the optional dishwasher)
  - 1 electric oven (Miele)

- Sliding top-counter part

#### ON STARBOARD

- L-shaped sofa with 4 storage cubbyholes
- 3 leather chairs
- 1 high wooden table (2.3 x 1.25 m/7'7" x 4'1")
- 1 storage unit with a flap

#### CENTRAL UNIT

- Cabinet with wooden and lacquered glass top
- 3 drawers (Slot for optional wine cave)

#### CHART TABLE

- Chart table equipped with electronics
- Dedicated seat
- Sliding desk with storage and leather top

#### PRIVATE LOUNGE

- 1 L-shaped sofa with 3 storage cubbyholes
- L-shaped storage locker
- Storage behind the seat with top access

Access to the forward cockpit by way of a glass door (PMMA)

## 5 cabins - Galley up version



### PORT HULL

#### Aft cabin:

- 2 single beds with side access (2.05 x 0.90 m/6'9" x 2'11") and slatted base, sliding and convertible into one double bed
- 1 central bedside table with stainless steel and leather insert
- 1 drawer under each bed
- 1 hanging locker - outboard side
- 1 storage locker- inboard side
- 1 T60 opening deck hatch
- 1 PMMA fixed hull window with 1 integrated T3 opening hull porthole

#### Aft bathroom:

- Corian® vanity top (Clam Shell) with integrated washbasin
- Hot and cold mixer tap
- High-level locker with 1 mirrored door and 3 cubbyholes
- Low-level locker with 2 doors
- Separated shower with Corian® floor (Clam Shell), peripheral draining and toughened glass swing doors
- Head shower and additional hand shower
- Electric freshwater toilet (Tecma)

**Mid-ship cabin:**

- 1 island double bed (2.05 x 1.67 m/6'9" x 5'6") with slatted base
- 2 storage drawers under the bed
- 2 bedside tables with coin tray and 2 drawers below
- 1 desk with flaps and shelves
- 1 leather chair (FRAG)
- 2 bedhead wall lamps
- 1 desk with flaps and shelves - outboard side
- 1 hanging locker and 1 storage unit on each side of the desk - outboard side
- 1 T60 opening deck hatch
- 1 PMMA fixed hull window with 1 integrated T3 opening hull porthole

**Mid-ship bathroom:**

- Corian® vanity top (Clam Shell) with integrated composite washbasin
- Hot and cold mixer tap
- High-level locker with 1 mirrored door and 3 cubbyholes
- 2 doors low-level locker
- Separated shower with Corian® floor (Clam Shell), peripheral draining and toughened glass swing doors
- Head shower and additional hand shower
- Electric freshwater toilet (Tecma)
- 1 T60 opening deck hatch

**Forward cabin:**

- 1 island double bed (2.05 x 1.70 m/6'9" x 5'7") with slatted base
- 2 bedside tables with, on each side:
  - Coin tray and double glass-holder
  - 2 storage drawers
- 4 storage drawers under the bed
- Unit with storage behind flap and double hanging locker in the upper section and 2 doors with 2 shelves in the lower section
- Outboard side:



- Desk with flap
- Bookcase with 3 shelves
- Low-level unit with 2 levels of shelves and 7 doors
- Unit with double doors providing 6 storage spaces in the upper section and 3 drawers in the lower section
- 1 T60 opening deck hatch
- 1 fixed hull window with 1 integrated opening hull port
- Door providing direct access to the bathroom

#### Forward cabin bathroom:

- Corian® vanity top (Clam Shell) with integrated composite washbasin
- High-level locker with 1 mirrored door and 3 cubbyholes
- 2 low-level drawers
- Separated shower with Corian® floor (Clam Shell), peripheral draining and toughened glass swing doors
- Head shower and additional hand shower
- 1 T60 opening deck hatch
- Electric freshwater toilet (Tecma)

#### STARBOARD HULL

##### Aft cabin:

- 1 island double bed (2.05 x 1.67 m/6'9" x 5'6") with slatted base
- 2 storage drawers under the bed
- 2 bedside tables with coin tray and 2 drawers on each side
- Inboard :
  - 1 unit with hanging locker in the upper section and shelf in the lower section
  - Low-level units with 1 shelf and 2 doors
  - 1 T60 opening deck hatch
  - 1 PMMA fixed hull window with 1 integrated T3 opening hull port
- Outboard :
  - 1 desk with 2 flaps and 3 shelves

- One low-level unit with 2 doors and shelves

#### Aft bathroom:

- Corian® vanity top (Clam Shell) with integrated washbasin
- Hot and cold water mixer tap
- High-level locker with 1 mirrored door and 3 cubbyholes
- Low-level storage unit with 2 drawers
- Separated shower with Corian® floor (Clam Shell), peripheral draining and toughened glass swing doors
- Head shower and additional hand shower
- Separated toilet :
  - 1 large storage unit with 2 mirrored doors with 4 shelves in the upper section and 2 drawers and 2 doors with shelves in the lower section
  - Electric freshwater toilet (Tecma)
- 1 PMMA fixed hull window with 1 integrated T3 opening hull port

#### Owner's suite:

- Access from the private lounge. Wooden sliding door
- Inboard :
  - 1 island double bed (2.05 x 1.80 m/6'9" x 5'11") with slatted base
  - 2 bedside tables with coin tray and 2 drawers on each side
  - Coin tray and double glass-holder
  - 4 storage drawers under the bed
  - 1 unit with 2 drawers in the lower section and a bookcase in the upper section
  - 1 desk with 2 flaps and 3-shelf bookcase
  - 1 wooden ottoman with storage locker
- Outboard :
  - 1 unit with storage in the lower section and bookcase in the upper section
  - Sofa with 2-shelf bookcase above and storage behind the seatback and under the seat
- 2 T60 opening deck hatches
- 2 PMMA fixed hull windows with 1 integrated T3 opening hull port

- Dressing :
  - Hanging lockers
  - 6 sliding shelves with leather insert and Plexiglas fiddle
  - 3 drawers inboard side
  - 2 drawers under hanging lockers
  - Trouser rack
  - 1 T60 opening deck hatch

**Owner's bathroom:**

- Corian® vanity top (Clam Shell) with integrated double washbasin
- High-level locker with :
  - 3 mirrored doors and shelves behind each door
  - 4 x 3 storage cubbyholes
- Low-level locker with 3 drawers
- Electric freshwater toilet (Tecma)
- Separated shower with Corian® floor (Clam Shell), peripheral draining and toughened glass door
- Head shower and additional hand shower
- 1 T60 opening deck hatch
- 1 PMMA fixed hull window with 1 integrated T3 opening hull port

## 6 cabins - Galley up version



### PORT HULL

#### Aft cabin:

- 2 single beds with side access (2.05 x 0.90 m/6'9" x 2'11") and slatted base, sliding and convertible into one double bed
- 1 central bedside table with stainless steel and leather insert
- 1 drawer under each bed
- 1 hanging locker - outboard side
- 1 storage locker- inboard side
- 1 T60 opening deck hatch
- 1 PMMA fixed hull window with 1 integrated T3 opening hull porthole

#### Aft bathroom:

- Corian® vanity top (Clam Shell) with integrated washbasin
- Hot and cold mixer tap
- High-level locker with 1 mirrored door and 3 cubbyholes
- Low-level locker with 2 doors
- Separated shower with Corian® floor (Clam Shell), peripheral draining and toughened glass swing doors
- Head shower and additional hand shower
- Electric freshwater toilet (Tecma)

**Mid-ship cabin:**

- 1 island double bed (2.05 x 1.67 m/6'9" x 5'6") with slatted base
- 2 storage drawers under the bed
- 2 bedside tables with coin tray and 2 drawers below
- 1 desk with flaps and shelves
- 1 leather chair (FRAG)
- 2 bedhead wall lamps
- 1 desk with flaps and shelves - outboard side
- 1 hanging locker and 1 storage unit on each side of the desk - outboard side
- 1 T60 opening deck hatch
- 1 PMMA fixed hull window with 1 integrated T3 opening hull porthole

**Mid-ship bathroom:**

- Corian® vanity top (Clam Shell) with integrated composite washbasin
- Hot and cold mixer tap
- High-level locker with 1 mirrored door and 3 cubbyholes
- 2 doors low-level locker
- Separated shower with Corian® floor (Clam Shell), peripheral draining and toughened glass swing doors
- Head shower and additional hand shower
- Electric freshwater toilet (Tecma)
- 1 T60 opening deck hatch

**Forward cabin:**

- 1 island double bed (2.05 x 1.70 m/6'9" x 5'7") with slatted base
- 2 bedside tables with, on each side:
  - Coin tray and double glass-holder
  - 2 storage drawers
- 4 storage drawers under the bed
- Unit with storage behind flap and double hanging locker in the upper section and 2 doors with 2 shelves in the lower section
- Outboard side with:

- Desk with flap
- 3-shelf bookcase
- 7-door low-level unit with 2 levels of shelves
- 1 unit with double doors providing 6 storage spaces in the upper section and 3 drawers in the lower section
- 1 T60 opening deck hatch
- 1 fixed hull window with 1 integrated opening hull port
- Door providing direct access to bathroom

#### Forward cabin bathroom:

- Corian® vanity top (Clam Shell) with integrated composite washbasin
- High-level locker with 1 mirrored door and 3 cubbyholes
- 2 low-level drawers
- Separated shower with Corian® floor (Clam Shell), peripheral draining and toughened glass swing doors
- Head shower and additional hand shower
- 1 T60 opening deck hatch
- Electric freshwater toilet (Tecma)

#### STARBOARD HULL

##### Aft cabin:

- 1 island double bed (2.05 x 1.67 m/6'9" x 5'6") with slatted base
- 2 storage drawers under the bed
- 2 bedside tables with coin tray and 2 drawers on each side
- Inboard :
  - 1 unit with hanging locker in the upper section and shelf in the lower section
  - Two 2-door low-level units with 1 shelf
  - 1 T60 opening deck hatch
  - 1 PMMA fixed hull window with 1 integrated T3 opening hull port
- Outboard :
  - 1 desk with 2 flaps and 3 shelves

- One 2-door low-level unit with shelves

#### Aft bathroom:

- Corian® vanity top (Clam Shell) with integrated washbasin
- Hot and cold water mixer tap
- High-level locker with 1 mirrored door and 3 cubbyholes
- Low level storage unit with 2 drawers
- Separated shower with Corian® floor (Clam Shell), peripheral draining and toughened glass swing doors
- Head shower and additional hand shower
- Separated toilet :
  - 1 large storage unit with 2 mirrored doors with 4 shelves in the upper section and 2 drawers and 2 doors with shelves in the lower section
  - Electric freshwater toilet (Tecma)
- 1 PMMA fixed hull window with 1 integrated T3 opening hull port

#### Mid-ship cabin:

- 2 single beds with side access (2.05 x 0.90 m/6'9" x 2'11") and slatted base
- 1 central bedside table with leather and stainless steel insert
- 1 drawer under each bed
- 1 hanging locker – outboard side
- 1 storage unit – inboard side
- 1 T60 opening deck hatch
- 1 PMMA fixed hull window with 1 integrated T3 opening hull port

#### Mid-ship bathroom:

- Corian® vanity top (Clam Shell) with integrated washbasin
- Hot and cold mixer tap
- High-level locker with 1 mirrored door
- 1-door low-level drawer
- Integrated shower with Corian® floor (Clam Shell), peripheral draining
- Head shower and additional hand shower

- 1 PMMA fixed hull window with 1 integrated T3 opening hull port
- Separated toilet, access from the cabin (independent):
  - 1 storage unit
  - Electric freshwater toilet (Tecma)

**Forward cabin:**

- 1 island double bed (2.05 x 1.760 m/6'9" x 5'9") with slatted base
- 2 storage drawers under the bed
- 2 bedside tables with coin tray and drawers underneath
- 1 storage unit + bookshelves – outboard side
- 1 hanging locker – inboard side
- 1 T60 opening deck hatch
- 1 PMMA fixed hull window with 1 integrated T3 opening hull port

**Forward cabin bathroom:**

- Corian® vanity top (Clam Shell) with integrated washbasin
- Hot and cold water mixer tap
- High-level locker with 1 mirrored door and 3 cubbyholes
- 2-door low-level drawer
- Separated shower with Corian® floor (Clam Shell), peripheral draining and toughened glass swing doors
- Head shower and additional hand shower
- Electric freshwater toilet (Tecma)
- 1 T60 opening deck hatch



## Saloon - Hull Galley version



- Access from the aft cockpit through a wide glazed sliding door (overall dimensions 3.8 x 1.95 m/12'6" x 6'5" - opening dimensions 2.3 x 1.95 m/7'7" x 6'5")

### TO PORT:

- Sofa with one storage locker
- 6 aluminum chairs (TRIBU)
- 1 aluminum dining table (TRIBU)
- 1 long furniture with storage: 3 shelves behind doors and 2 niches

### ON STARBOARD:

- U-shaped sofa with 3 storage lockers under seating
- 1 low table/ottoman, fabric covered (1.5 x 0.9 m/4'11" x 2'11")
- 1 storage unit

### CENTRAL UNIT:

- Cabinet with leather top, storage, bar equipment and sink in Corian® (Graylite), doors on each side

## CHART TABLE

- Chart table equipped with electronics
- Dedicated seat
- Sliding desk with storage and leather top

## PRIVATE LOUNGE

- 1 L-shaped sofa with 3 storage lockers opposite a seat
- Storage behind seat with top access and Plexiglas separations
- Access to the forward cockpit by way of a glass door (PMMA)

**4 cabin version - Forward galley****PORT HULL****Aft cabin:**

- 2 single beds with side access (2.05 x 0.90 m/6'9" x 2'11") and slatted base, sliding and convertible into one double bed
- 1 central bedside table with stainless steel and leather insert
- 1 drawer under each bed
- 1 hanging locker – outboard side
- 1 storage locker- inboard side
- 1 T60 opening deck hatch
- 1 PMMA fixed hull window with 1 integrated T3 opening hull porthole

**Aft bathroom:**

- Corian® vanity top (Clam Shell) with integrated washbasin
- Hot and cold mixer tap
- High-level locker with 1 mirrored door and 3 cubbyholes
- 2 doors low-level locker
- Separated shower with Corian® floor (Clam Shell), peripheral draining and toughened glass swing doors
- Head shower and additional hand shower

- Electric freshwater toilet (Tecma)

#### Mid-ship cabin:

- 1 island double bed (2.05 x 1.67 m/6'9" x 5'6") with slatted base
- 2 storage drawers under the bed
- 2 bedside tables with coin tray and 2 drawers below
- 1 desk with flaps and shelves
- 1 leather chair (FRAG)
- 2 bedhead wall lamps
- 1 desk with flaps and shelves - outboard side
- 1 hanging locker and 1 storage unit on each side of the desk - outboard side
- 1 T60 opening deck hatch
- 1 PMMA fixed hull window with 1 integrated T3 opening hull porthole

#### Mid-ship bathroom:

- Corian® vanity top (Clam Shell) with integrated composite washbasin
- Hot and cold mixer tap
- High-level locker with 1 mirrored door and 3 cubbyholes
- 2 doors low-level locker
- Separated shower with Corian® floor (Clam Shell), peripheral draining and toughened glass swing doors
- Head shower and additional hand shower
- Electric freshwater toilet (Tecma)
- 1 T60 opening deck hatch

#### Forward galley:

- Access from the port forward companionway
- Large opening deck hatch for direct access from the deck through a retractable electrical staircase
- 1 PMMA fixed hull window with 1 integrated T3 opening hull port

- Outboard :
  - Combined refrigerator/freezer with integrated icemaker (Samsung - Volume 396 L+124 L/105 US Gal+33 US Gal)
  - Corian® (Deep Mink) worktop with stainless steel double sink and hot and cold mixer tap
  - 2 doors locker under sink
  - 1 waste receptacle with access from above and door at front
  - 1 door low-level unit with shelves
  - 1 low-level unit with 4 drawers
  - High-level lockers with flaps
  - 1 PMMA fixed hull window with 1 integrated T3 opening hull port
  
- Inboard:
  - Corian® (Deep Mink) worktop
  - Corian® (Deep Mink) dining table with bench seat and storage
  - 1 x 4-burner induction hob 230V (Miele) and pan clamps
  - 1 electric oven (Miele)
  - 1 extractor hood (Electrolux)
  - High and low-level lockers with doors, shelves and drawers

### Crew cabin

- 2 bunk beds (2.05 x 0.90 m/6'9" x 2'11") with slatted bases
- 1 drawer under the bed
- 1 hanging locker and 1 storage unit – inboard side
- 1 stowage unit capable of housing the washer/dryer (optional)
- 1 T60 opening deck hatch

### Crew bathroom

- Corian® vanity top (Deep Mink) with integrated washbasin
- Hot and cold mixer tap
- High-level locker with 1 mirrored door and 3 cubbyholes
- Low-level locker with 2 doors

- High- and low-level lockers
- Separated shower with Corian® floor (Deep Mink), peripheral draining
- Head shower and additional hand shower
- Electric freshwater toilet (Tecma)

## STARBOARD HULL

### Aft cabin:

- 1 island double bed (2.05 x 1.67 m/6'9" x 5'6") with slatted base
- 2 storage drawers under the bed
- 2 bedside tables with coin tray and 2 drawers on each side
- Inboard :
  - 1 unit with hanging locker in the upper section and shelf in the lower section
  - Two 2-door low-level units with 1 shelf
  - 1 T60 opening deck hatch
  - 1 PMMA fixed hull window with 1 integrated T3 opening hull port
- Outboard :
  - 1 desk with 2 flaps and 3 shelves
  - One 2-door low-level unit with shelves

### Aft bathroom:

- Corian® vanity top (Clam Shell) with integrated washbasin
- Hot and cold water mixer tap
- High-level locker with 1 mirrored door and 3 cubbyholes
- Low level storage unit with 2 drawers
- Separated shower with Corian® floor (Clam Shell), peripheral draining and toughened glass swing doors
- Head shower and additional hand shower
- Separated toilet :
  - 1 large storage unit with 2 mirrored doors with 4 shelves in the upper section and 2 drawers and 2 doors with shelves in the lower section
  - Electric freshwater toilet (Tecma)

- 1 PMMA fixed hull window with 1 integrated T3 opening hull port

Owner's suite:

- Access from the private lounge. Wooden sliding door
- Inboard :
  - 1 island double bed (2.05 x 1.80 m/6'9" x 5'11") with slatted base
  - 2 bedside tables with coin tray and 2 drawers on each side
  - Coin tray and double glass-holder
  - 4 storage drawers under the bed
  - 1 unit with 2 drawers in the lower section and a bookcase in the upper section
  - 1 desk with 2 flaps, 3-shelf bookcase
  - 1 wooden ottoman with storage locker
- Outboard :
  - 1 unit with storage in the lower section and bookcase in the upper section
  - Sofa with 2-shelf bookcase above and storage behind the seatback and under the seat
- 2 T60 opening deck hatches
- 2 PMMA fixed hull windows with 1 integrated T3 opening hull port
- Dressing :
  - Hanging lockers
  - 6 sliding shelves with leather insert and Plexiglas fiddle
  - 3 drawers inboard side
  - 2 drawers under hanging lockers
  - Trouser rack
  - 1 T60 opening deck hatch

Owner's bathroom:

- Corian® vanity top (Clam Shell) with integrated double washbasin
- High-level locker with :
  - 3 mirrored doors and shelves behind each door

- 4 x 3 storage cubbyholes
- 3-drawer low-level locker
- Electric freshwater toilet (Tecma)
- Separated shower with Corian® floor (Clam Shell), peripheral draining and toughened glass door
- Head shower and additional hand shower
- 1 T60 opening deck hatch
- 1 PMMA fixed hull window with 1 integrated T3 opening hull port



## 5 cabin version - Forward galley

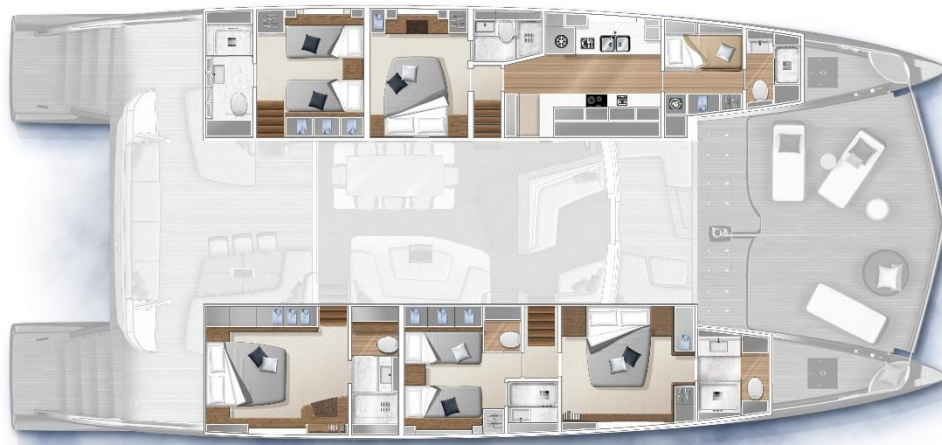

### PORT HULL

#### Aft cabin:

- 2 single beds with side access (2.05 x 0.90 m/6'9" x 2'11") and slatted base, sliding and convertible into one double bed
- 1 central bedside table with stainless steel and leather insert
- 1 drawer under each bed
- 1 hanging locker - outboard side
- 1 storage locker- inboard side
- 1 T60 opening deck hatch
- 1 PMMA fixed hull window with 1 integrated T3 opening hull porthole

#### Aft bathroom:

- Corian® vanity top (Clam Shell) with integrated washbasin
- Hot and cold mixer tap
- High-level locker with 1 mirrored door and 3 cubbyholes
- 2 doors low-level locker
- Separated shower with Corian® floor (Clam Shell), peripheral draining and toughened glass swing doors
- Head shower and additional hand shower

- Electric freshwater toilet (Tecma)

#### Mid-ship cabin:

- 1 island double bed (2.05 x 1.67 m/6'9" x 5'6") with slatted base
- 2 storage drawers under the bed
- 2 bedside tables with coin tray and 2 drawers below
- 1 desk with flaps and shelves
- 1 leather chair (FRAG)
- 2 bedhead wall lamps
- 1 desk with flaps and shelves - outboard side
- 1 hanging locker and 1 storage unit on each side of the desk - outboard side
- 1 T60 opening deck hatch
- 1 PMMA fixed hull window with 1 integrated T3 opening hull porthole

#### Mid-ship bathroom:

- Corian® vanity top (Clam Shell) with integrated composite washbasin
- Hot and cold mixer tap
- High-level locker with 1 mirrored door and 3 cubbyholes
- 2 doors low-level locker
- Separated shower with Corian® floor (Clam Shell), peripheral draining and toughened glass swing doors
- Head shower and additional hand shower
- Electric freshwater toilet (Tecma)
- 1 T60 opening deck hatch

#### Forward galley:

- Access from the port forward companionway
- Large opening deck hatch (T60) for direct access from the deck through a retractable electrical staircase
- 1 PMMA fixed hull window with 1 integrated T3 opening hull port

- Outboard :
  - Combined refrigerator/freezer with integrated icemaker (Samsung - Volume 396 L+124 L/105 US Gal+33 US Gal)
  - Corian® (Deep Mink) worktop with stainless steel double sink and hot and cold mixer tap
  - 2 doors locker under sink
  - 1 waste receptacle with access from above and door at front
  - 1 door low-level unit with shelves
  - 1 low-level unit with 4 drawers
  - High-level lockers with flaps
  - 1 PMMA fixed hull window with 1 integrated T3 opening hull port
  
- Inboard:
  - Corian® (Deep Mink) worktop
  - Corian® (Deep Mink) dining table with bench seat and storage
  - 1 x 4-burner induction hob 230V (Miele) and pan clamps
  - 1 electric oven (Miele)
  - 1 extractor hood (Electrolux)
  - High and low-level lockers with doors, shelves and drawers

### Crew cabin

- 2 bunk beds (22.05 x 0.90 m/6'9" x 2'11") with slatted bases
- 1 drawer under the bed
- 1 hanging locker and 1 storage unit – inboard side
- 1 stowage unit capable of housing the washer/dryer (optional)
- 1 T60 opening deck hatch

### Crew bathroom

- Corian® vanity top (Deep Mink) with integrated washbasin
- Hot and cold mixer tap
- High-level locker with 1 mirrored door and 3 cubbyholes
- Low-level locker with 2 doors

- High- and low-level lockers
- Separated shower with Corian® floor (Deep Mink), peripheral draining
- Head shower and additional hand shower
- Electric freshwater toilet (Tecma)

## STARBOARD HULL

### Aft cabin:

- 1 island double bed (2.05 x 1.67 m/6'9" x 5'6") with slatted base
- 2 storage drawers under the bed
- 2 bedside tables with coin tray and 2 drawers on each side
- Inboard :
  - 1 unit with hanging locker in the upper section and shelf in the lower section
  - Two 2-door low-level units with 1 shelf
  - 1 T60 opening deck hatch
  - 1 PMMA fixed hull window with 1 integrated T3 opening hull port
- Outboard :
  - 1 desk with 2 flaps and 3 shelves
  - One 2-door low-level unit with shelves

### Aft bathroom:

- Corian® vanity top (Clam Shell) with integrated washbasin
- Hot and cold water mixer tap
- High-level locker with 1 mirrored door and 3 cubbyholes
- Low level storage unit with 2 drawers
- Separated shower with Corian® floor (Clam Shell), peripheral draining and toughened glass swing doors
- Head shower and additional hand shower
- Separated toilet :
  - 1 large storage unit with 2 mirrored doors with 4 shelves in the upper section and 2 drawers and 2 doors with shelves in the lower section
  - Electric freshwater toilet (Tecma)

- 1 PMMA fixed hull window with 1 integrated T3 opening hull port

#### Mid-ship cabin:

- 2 single beds with side access (2.05 x 0.90 m/6'9" x 2'11") and slatted base
- 1 central bedside table with leather and stainless steel insert
- 1 drawer under each bed
- 1 hanging locker – outboard side
- 1 storage unit – inboard side
- 1 T60 opening deck hatch
- 1 PMMA fixed hull window with 1 integrated T3 opening hull port

#### Mid-ship bathroom:

- Corian® vanity top (Clam Shell) with integrated washbasin
- Hot and cold mixer tap
- High-level locker with 1 mirrored door
- 1-door low-level drawer
- Integrated shower with Corian® floor (Clam Shell), peripheral draining
- Head shower and additional hand shower
- 1 PMMA fixed hull window with 1 integrated T3 opening hull port
- Separated toilet, access from the cabin (independent):
  - 1 storage unit
  - Electric freshwater toilet (Tecma)

#### Forward cabin:

- 1 island double bed (2.05 x 1.760 m/6'9" x 5'9") with slatted base
- 2 storage drawers under the bed
- 2 bedside tables with coin tray and drawers underneath
- 1 storage unit + bookshelves – outboard side
- 1 hanging locker – inboard side
- 1 T60 opening deck hatch
- 1 PMMA fixed hull window with 1 integrated T3 opening hull port

**Forward cabin bathroom:**

- Corian® vanity top (Clam Shell) with integrated washbasin
- Hot and cold water mixer tap
- High-level locker with 1 mirrored door and 3 cubbyholes
- 2-door low-level drawer
- Separated shower with Corian® floor (Clam Shell), peripheral draining and toughened glass swing doors
- Head shower and additional hand shower
- Electric freshwater toilet (Tecma)
- 1 T60 opening deck hatch

### 3 cabin version - Aft galley



#### PORT HULL

##### Galley

- Access from the aft cockpit or from the saloon by way of the crew cabin
- 1 T60 opening deck hatch
- 1 PMMA fixed hull window with 1 integrated T3 opening hull port
  
- Outboard:
  - Corian® (Deep Mink) worktop with double stainless steel with hot and cold mixer tap
  - 1 waste receptacle with access from above and door at front
  - 1 x 1-door low-level unit with shelves
  - 1 low-level unit with 4 drawers
  - 1 x 4-burner induction hob, 230V, (Miele), and pan clamps
  - 1 Electric oven (Miele), 1 drawer below
  - 1 extractor hood (Electrolux)
  - Storage unit for bottles
  - High level lockers with flaps

- Aft bulkhead :
  - Combined refrigerator/freezer with integral icemaker (Samsung - Volume 396 L+124 L/105 US Gal+33 US Gal)
  - 1 storage locker under the floor
  - To the left of the refrigerator:
    - 1 storage unit with :
      - 2 high level locker  
(Replaced in case of optional coffee machine/ Microwave)
      - 2 drawers in the lower section
    - 1 storage locker in the lower section
  
- Inboard :
  - 1 storage unit with:
    - 1 large locker with 1 door and 3 shelves in the upper section
    - 1 storage compartment with flap in the lower section
  - Storage under the companionway stairs
  - Dinette with:
    - Corian® (Deep Mink) dining table with stainless steel pedestal
    - 2 facing bench seats with storage under settees
    - 2 lockers with doors and shelves
    - Open shelves (deleted in case of optional TV)
    - 2 high-level lockers with flaps

### Crew cabin

- Access from the gangway or the galley
- Inboard :
  - 2 bunk beds with side access (2.05 x 0.90 m/6'9" x 2'11") and slatted base
  - Storage along the bulkhead with sliding doors
  - 1 drawer under the bed
  - 1 unit with 1 hanging locker in the upper section and 1 locker with 2 shelves in the lower section



- Outboard :
  - 1 unit with 1 door and 3 shelves in the upper section and 1 door and 2 shelves in the lower section (replaced in case of optional washing machine or dryer or washer-dryer)
  - 1 desk with 1 flap and seat
  - 1 x 1-door low-level locker
  - 3 high-level lockers with flaps
- 1 T60 opening deck hatch
- 1 PMMA fixed hull window with 1 integrated T3 opening hull port

#### Crew bathroom:

- Corian® vanity top (Clam Shell) with integrated washbasin
- Hot and cold mixer tap
- High-level locker with 1 mirrored door and 3 cubbyholes
- 2-door low-level locker
- Separated shower with Corian® floor (Clam Shell), peripheral draining and toughened glass swing doors
- Head shower and additional hand shower
- 1 T60 opening deck hatch
- Electric freshwater toilet (Tecma)
- Corian® floor (Clam Shell)

#### Forward cabin:

- 1 island double bed (2.05 x 1.70 m/6'9" x 5'7") with slatted base
- 2 bedside tables with, on each side:
  - Coin tray and double glass-holder
  - 2 storage drawers
- 4 storage drawers under the bed
- Unit with storage behind flap and double hanging locker in the upper section and 2 doors with 2 shelves in the lower section
- Outboard side with:
  - Desk with flap

- 3-shelf bookcase
- 7-door low-level unit with 2 levels of shelves
- 1 unit with double doors providing 6 storage spaces in the upper section and 3 drawers in the lower section
- 1 T60 opening deck hatch
- 1 fixed hull window with 1 integrated opening hull port
- Door providing direct access to bathroom

#### Forward cabin bathroom:

- Corian® vanity top (Clam Shell) with integrated composite washbasin
- High-level locker with 1 mirrored door and 3 cubbyholes
- 2 low-level drawers
- Separated shower with Corian® floor (Clam Shell), peripheral draining and toughened glass swing doors
- Head shower and additional hand shower
- 1 T60 opening deck hatch
- Electric freshwater toilet (Tecma)

#### STARBOARD HULL

##### Aft cabin:

- 1 island double bed (2.05 x 1.67 m/6'9" x 5'6") with slatted base
- 2 storage drawers under the bed
- 2 bedside tables with coin tray and 2 drawers on each side
- Inboard :
  - 1 unit with hanging locker in the upper section and shelf in the lower section
  - Two 2-door low-level units with 1 shelf
  - 1 T60 opening deck hatch
  - 1 PMMA fixed hull window with 1 integrated T3 opening hull port
- Outboard :
  - 1 desk with 2 flaps and 3 shelves

- One 2-door low-level unit with shelves

#### Aft bathroom:

- Corian® vanity top (Clam Shell) with integrated washbasin
- Hot and cold water mixer tap
- High-level locker with 1 mirrored door and 3 cubbyholes
- Low level storage unit with 2 drawers
- Separated shower with Corian® floor (Clam Shell), peripheral draining and toughened glass swing doors
- Head shower and additional hand shower
- Separated toilet :
  - 1 large storage unit with 2 mirrored doors with 4 shelves in the upper section and 2 drawers and 2 doors with shelves in the lower section
  - Electric freshwater toilet (Tecma)
- 1 PMMA fixed hull window with 1 integrated T3 opening hull port

#### Owner's suite:

- Access from the private lounge. Wooden sliding door
- Inboard :
  - 1 island double bed (2.05 x 1.80 m/6'9" x 5'11") with slatted base
  - 2 bedside tables with coin tray and 2 drawers on each side
  - Coin tray and double glass-holder
  - 4 storage drawers under the bed
  - 1 unit with 2 drawers in the lower section and a bookcase in the upper section
  - 1 desk with 2 flaps, 3-shelf bookcase
  - 1 wooden ottoman with storage locker
- Outboard :
  - 1 unit with storage in the lower section and bookcase in the upper section
  - Sofa with 2-shelf bookcase above and storage behind the seatback and under the seat
- 2 T60 opening deck hatches

- 2 PMMA fixed hull windows with 1 integrated T3 opening hull port
  
- Dressing:
  - Hanging lockers
  - 6 sliding shelves with leather insert and Plexiglas fiddle
  - 3 drawers inboard side
  - 2 drawers under hanging lockers
  - Trouser rack
  - 1 T60 opening deck hatch

#### Owner's bathroom:

- Corian® vanity top (Clam Shell) with integrated double washbasin
- High-level locker with :
  - 3 mirrored doors and shelves behind each door
  - 4 x 3 storage cubbyholes
- 3-drawer low-level locker
- Electric freshwater toilet (Tecma)
- Separated shower with Corian® floor (Clam Shell), peripheral draining and toughened glass door
- Head shower and additional hand shower
- 1 T60 opening deck hatch
- 1 PMMA fixed hull window with 1 integrated T3 opening hull port

**4 cabin version - Aft galley****PORT HULL****Galley**

- Access from the aft cockpit or from the saloon by way of the crew cabin
- 1 T60 opening deck hatch
- 1 PMMA fixed hull window with 1 integrated T3 opening hull port
  
- Outboard:
  - Corian® (Deep Mink) worktop with double stainless steel with hot and cold mixer tap
  - 1 waste receptacle with access from above and door at front
  - 1 x 1-door low-level unit with shelves
  - 1 low-level unit with 4 drawers
  - 1 x 4-burner induction hob, 230V, (Miele), and pan clamps
  - 1 Electric oven (Miele), 1 drawer below
  - 1 extractor hood (Electrolux)
  - Storage unit for bottles
  - High level lockers with flaps

- Aft bulkhead :
  - Combined refrigerator/freezer with integral icemaker (Samsung - Volume 396 L+124 L/105 US Gal+33 US Gal)
  - 1 storage locker under the floor
  - To the left of the refrigerator:
    - 1 storage unit with :
      - 2 high level locker  
(Replaced in case of optional coffee machine/ Microwave)
      - 2 drawers in the lower section
    - 1 storage locker in the lower section
  
- Inboard :
  - 1 storage unit with:
    - 1 large locker with 1 door and 3 shelves in the upper section
    - 1 storage compartment with flap in the lower section
  - Storage under the companionway stairs
  - Dinette with:
    - Corian® (Deep Mink) dining table with stainless steel pedestal
    - 2 facing bench seats with storage under settees
    - 2 lockers with doors and shelves
    - Open shelves (deleted in case of optional TV)
    - 2 high-level lockers with flaps

### Crew cabin

- Access from the gangway or the galley
- Inboard :
  - 2 bunk beds with side access (2.05 x 0.90 m/6'9" x 2'11") and slatted base
  - Storage along the bulkhead with sliding doors
  - 1 drawer under the bed
  - 1 unit with 1 hanging locker in the upper section and 1 locker with 2 shelves in the lower section

- Outboard :
  - 1 unit with 1 door and 3 shelves in the upper section and 1 door and 2 shelves in the lower section (replaced in case of optional washing machine or dryer or washer-dryer)
  - 1 desk with 1 flap and seat
  - 1 x 1-door low-level locker
  - 3 high-level lockers with flaps
- 1 T60 opening deck hatch
- 1 PMMA fixed hull window with 1 integrated T3 opening hull port

#### Crew bathroom:

- Corian® vanity top (Clam Shell) with integrated washbasin
- Hot and cold mixer tap
- High-level locker with 1 mirrored door and 3 cubbyholes
- 2-door low-level locker
- Separated shower with Corian® floor (Clam Shell), peripheral draining and toughened glass swing doors
- Head shower and additional hand shower
- 1 T60 opening deck hatch
- Electric freshwater toilet (Tecma)
- Corian® floor (Graylite)

#### Forward cabin:

- 1 island double bed (2.05 x 1.70 m/6'9" x 5'7") with slatted base
- 2 bedside tables with, on each side:
  - Coin tray and double glass-holder
  - 2 storage drawers
- 4 storage drawers under the bed
- Unit with storage behind flap and double hanging locker in the upper section and 2 doors with 2 shelves in the lower section
- Outboard side with:
  - Desk with flap

- 3-shelf bookcase
- 7-door low-level unit with 2 levels of shelves
- 1 unit with double doors providing 6 storage spaces in the upper section and 3 drawers in the lower section
- 1 T60 opening deck hatch
- 1 fixed hull window with 1 integrated opening hull port
- Door providing direct access to bathroom

#### Forward cabin bathroom:

- Corian® vanity top (Clam Shell) with integrated composite washbasin
- High-level locker with 1 mirrored door and 3 cubbyholes
- 2 low-level drawers
- Separated shower with Corian® floor (Clam Shell), peripheral draining and toughened glass swing doors
- Head shower and additional hand shower
- 1 T60 opening deck hatch
- Electric freshwater toilet (Tecma)

#### STARBOARD HULL

##### Aft cabin:

- 1 island double bed (2.05 x 1.67 m/6'9" x 5'6") with slatted base
- 2 storage drawers under the bed
- 2 bedside tables with coin tray and 2 drawers on each side
- Inboard :
  - 1 unit with hanging locker in the upper section and shelf in the lower section
  - Two 2-door low-level units with 1 shelf
  - 1 T60 opening deck hatch
  - 1 PMMA fixed hull window with 1 integrated T3 opening hull port



- Outboard :
  - 1 desk with 2 flaps and 3 shelves
  - One 2-door low-level unit with shelves

#### Aft bathroom:

- Corian® vanity top (Clam Shell) with integrated washbasin
- Hot and cold water mixer tap
- High-level locker with 1 mirrored door and 3 cubbyholes
- Low level storage unit with 2 drawers
- Separated shower with Corian® floor (Clam Shell), peripheral draining and toughened glass swing doors
- Head shower and additional hand shower
- Separated toilet :
  - 1 large storage unit with 2 mirrored doors with 4 shelves in the upper section and 2 drawers and 2 doors with shelves in the lower section
  - Electric freshwater toilet (Tecma)
- 1 PMMA fixed hull window with 1 integrated T3 opening hull port

#### Mid-ship cabin:

- 2 single beds with side access (2.05 x 0.90 m/6'9" x 2'11") and slatted base
- 1 central bedside table with leather and stainless steel insert
- 1 drawer under each bed
- 1 hanging locker – outboard side
- 1 storage unit – inboard side
- 1 T60 opening deck hatch
- 1 PMMA fixed hull window with 1 integrated T3 opening hull port

#### Mid-ship bathroom:

- Corian® vanity top (Clam Shell) with integrated washbasin
- Hot and cold mixer tap
- High-level locker with 1 mirrored door
- 1-door low-level drawer

- Integrated shower with Corian® floor (Clam Shell), peripheral draining
- Head shower and additional hand shower
- 1 PMMA fixed hull window with 1 integrated T3 opening hull port
- Separated toilet, access from the cabin (independent) :
  - 1 storage unit
  - Electric freshwater toilet (Tecma)

**Forward cabin:**

- 1 island double bed (2.05 x 1.760 m/6'9" x 5'9") with slatted base
- 2 storage drawers under the bed
- 2 bedside tables with coin tray and drawers underneath
- 1 storage unit + bookshelves – outboard side
- 1 hanging locker – inboard side
- 1 T60 opening deck hatch
- 1 PMMA fixed hull window with 1 integrated T3 opening hull port

**Forward cabin bathroom:**

- Corian® vanity top (Clam Shell) with integrated washbasin
- Hot and cold water mixer tap
- High-level locker with 1 mirrored door and 3 cubbyholes
- 2-door low-level drawer
- Separated shower with Corian® floor (Clam Shell), peripheral draining and toughened glass swing doors
- Head shower and additional hand shower
- Electric freshwater toilet (Tecma)
- 1 T60 opening deck hatch



162, quai de Brazza  
CS 81217  
33072 Bordeaux Cedex - France  
Tél. 33 + (0) 557 80 92 80  
E-mail : [info@cata-lagoon.com](mailto:info@cata-lagoon.com)  
[www.cata-lagoon.com](http://www.cata-lagoon.com)